



# ANSI-SPRI ES-1

## Douglass Colony Group Passes ANSI-SPRI ES-1 Testing

Douglass Colony Group recently passed ANSI/SPRI ES-1 testing to verify performance to SPRI RE-2, showing that its metal edge securements meet the wind design standard for edge systems used with low slope roofing systems. Douglass Colony Group is now listed as an authorized fabricator under NRCA's listing for metal edge systems and as indicated by the testing company, Douglass Colony Group is the only company in the state to have achieved this testing standard.

"With the incorporation of ANSI/SPRI ES-1 into the International Building Code, 2003 Edition (IBC 2003), compliance with ANSI/SPRI ES-1 became a building code requirement." NRCA Professional Roofing magazine

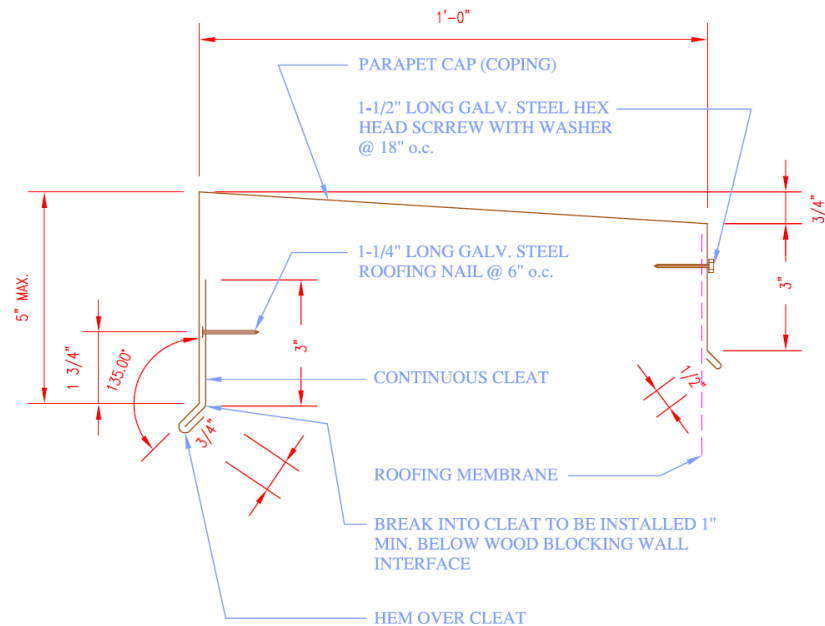

## Why Use Douglass Colony Group?

- Douglass Colony Group features a local 70,000 sq/ft fabrication facility at the Commerce City headquarters
- Douglass Colony Group uses in-house designers for complete design/build services
- Douglass Colony Group utilizes multiple material sources for more options and better customer value
- Douglass Colony Group offers fully tested and engineered systems to meet any specification and application

***We've Got You Covered From the Ground Up!***

**Give Us a Call Today!**

**(303)288-2635 or Toll Free at 1(877)288-0650**