



# Composite Metal Panels

## 8000 Series

The 8000 series is a high performance composite metal panel infill system designed to fully integrate into aluminum window systems. Panels can be fabricated to custom sizes and may be used as replacement or accent panels within the window system.

### System Info:

- Approximately 2 psf panel weight
- Variable joint widths available
- Up to 5ft x 15ft panel sizes
- Insulation options
- Flush or recessed options
- Impact resistant options
- Up to 30 year finish warranty

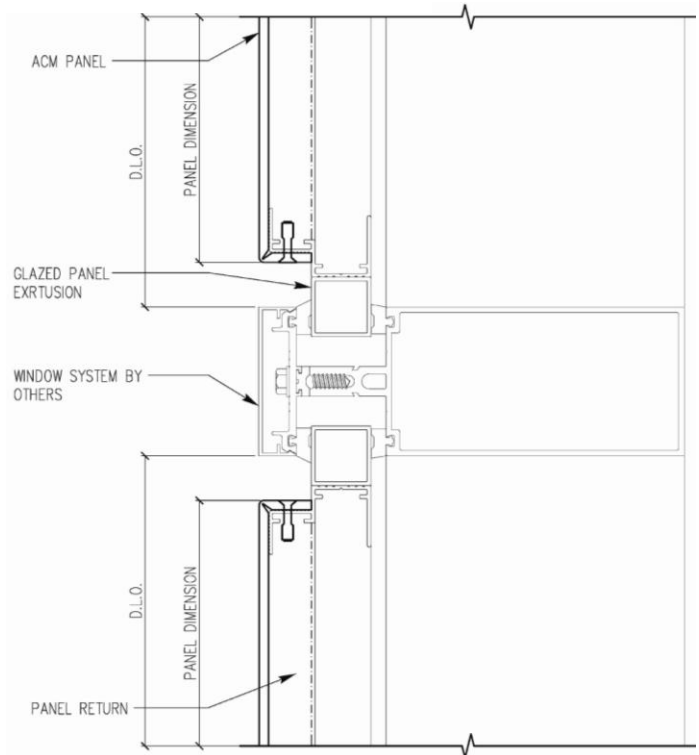

### Why Use Douglass Colony Group?

- Douglass Colony Group features a local 70,000 sq/ft fabrication facility at the Commerce City headquarters
- Douglass Colony Group uses in-house designers for complete design/build services
- Douglass Colony Group utilizes multiple material sources for more options and better customer value
- Douglass Colony Group offers fully tested and engineered systems to meet any specification and application

***We've Got You Covered From the Ground Up!***

**Give Us a Call Today!**

**(303)288-2635 or Toll Free at 1(877)288-0650**